



Mayor's Office of the National Western Center

**PHASES 1 & 2**  
**CONSTRUCTION UPDATE**  
**CITIZEN'S ADVISORY COMMITTEE**

IMAGINE. DISCOVER. CULTIVATE.

January 30, 2020

# PHASE 1 & 2 | ROLES & RESPONSIBILITIES

## BUILD IT



### Mayor's Office of the National Western Center

- Responsible for NWC Phases 1 & 2 of Construction.
- Principal Land and Facility Owner.
- Signed 100-Year Lease with NWC Authority for management of the campus.

## FILL IT



## AUTHORITY

### NWC Authority

- Non-profit Colorado Corporation with 100-Year Lease for the Campus.
- Responsible for campus programming, bookings, long-term operations and maintenance.
- Guided by a 13-member Board.
- Fulfill the campus vision of the master plan.

## SHOW IT



### NWSS / WSSA

- 100-Year Lease with NWC Authority.
- Produces the National Western Stock Show, Rodeo All-Star Weekend and Denver County Fair.
- Books other year-round equestrian and livestock events with the NWC Authority.
- Independent parcel owner for Legacy Building.

## KNOW IT



### Colorado State University System

- Independent parcel owner of the 3 funded CSU educational facilities focused on water, food, and human and animal health.
- Provides year-round programming.



# PHASES 1 & 2 PROGRAM CONTRACTS

UPDATED 01.22.2020

<b>Campus Placemaking</b> <b>MIG, Inc.</b> <ul style="list-style-type: none"> <li>Design</li> <li>M/WBE Goal of 25%</li> </ul>	<b>Integrated Demolition</b> <b>Saunders Construction</b> <ul style="list-style-type: none"> <li>Integrated Demolition</li> <li>M/WBE Goal of 18%</li> </ul>	<b>Brighton Boulevard - 3</b> <b>Kiewit / Hamon</b> <ul style="list-style-type: none"> <li>Integrated Construction</li> <li>M/WBE Goal of 14%</li> </ul>	<b>Maintenance &amp; Ops</b> <b>SEH, Inc.</b> <ul style="list-style-type: none"> <li>Design</li> <li>M/WBE Goal of 30%</li> </ul>	<b>Maintenance &amp; Ops</b> <b>GH Phipps</b> <ul style="list-style-type: none"> <li>CM/GC</li> <li>M/WBE Goal of 33%</li> </ul>
<b>DRIR Railroad</b> <b>Wilson &amp; Company</b> <ul style="list-style-type: none"> <li>Design</li> <li>M/WBE Goal of 14%</li> </ul>	<b>Horizontal Portfolio</b> <b>Merrick &amp; Company</b> <ul style="list-style-type: none"> <li>Design</li> <li>M/WBE Goal of 23%</li> </ul>	<b>Horizontal Integrated</b> <b>Hensel Phelps</b> <ul style="list-style-type: none"> <li>Integrated Construction</li> <li>M/WBE Goals - work order</li> </ul>	<b>Stockyards / Event Ctr.</b> <b>HKS</b> <ul style="list-style-type: none"> <li>Design</li> <li>M/WBE Goal of 30%</li> </ul>	<b>Stockyard Event Ctr. *</b> <b>Adolfson and Peterson</b> <ul style="list-style-type: none"> <li>CM/GC</li> <li>M/WBE Goal of 17%</li> </ul>
<b>Equestrian Center &amp; Parking Garage</b> <b>Populous</b> <ul style="list-style-type: none"> <li>Design</li> <li>M/WBE Goal of 24%</li> </ul>	<b>Equestrian Center &amp; Parking Garage</b> <b>Whiting Turner</b> <ul style="list-style-type: none"> <li>CM/GC (Pending City Council approval)</li> <li>M/WBE Goal of 20%</li> </ul>	<b>Livestock Center</b> <b>Populous</b> <ul style="list-style-type: none"> <li>Design</li> <li>M/WBE Goal 24%</li> </ul>	<b>Livestock Center</b> <b>Active Procurement</b> <ul style="list-style-type: none"> <li>CM/GC - TBD</li> <li>M/WBE Goal 19%</li> </ul>	<b>Campus District Energy</b> <b>Active Procurement</b> <ul style="list-style-type: none"> <li>EAS Partners</li> <li>Predevelopment Phase</li> </ul>



# WHAT WE ARE BUILDING

1. RTD Transit Station
2. Brighton Blvd. – 47<sup>th</sup> to Race Court
3. South Platte Riverfront
4. New National Western Drive
5. Stockyards/Event Center Multi-Use Space
6. Campus-Related TOD
7. New Bridges Near 48<sup>th</sup> & 51<sup>st</sup> Avenues
8. Livestock Center
9. Equestrian Center
10. Underground Parking
11. CSU System Spur: Health
12. CSU System Spur: Water
13. CSU System Spur: Food
14. Maintenance & Operations Facility
15. DRIR Rail Corridor
16. WSSA Legacy Building HQ
17. Pedestrian Bridge

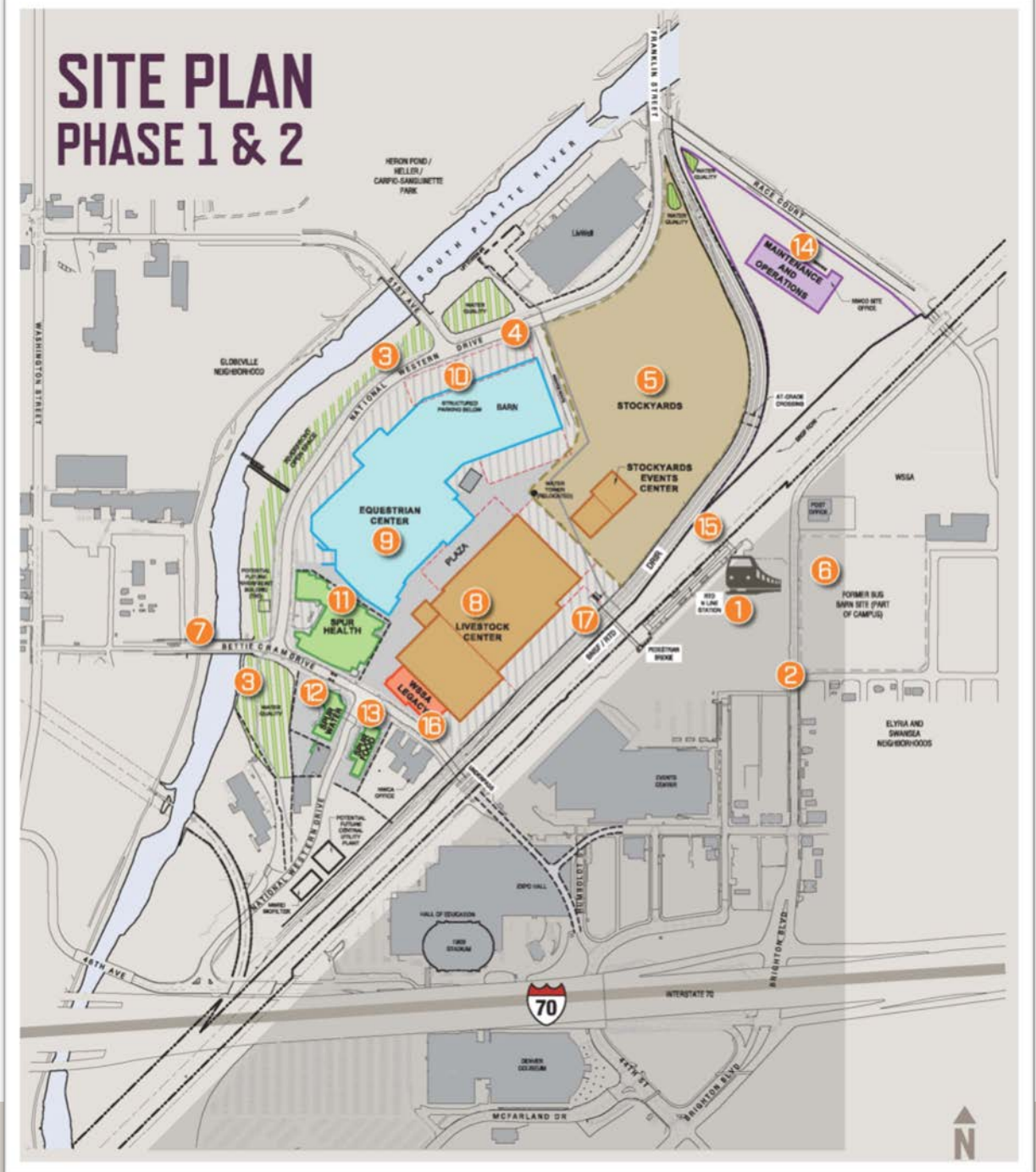



**BE IN THE KNOW! RIGHT ON YOUR PHONE!**

**NATIONAL WESTERN CENTRAL**

**TEXT UPDATES**

**64600**

**FOR CONSTRUCTION, NEWS AND EVENTS INFORMATION**



Sitework

M&O

Rail Work

SYEC

Concurrent Ops

Rail Work





ber 2019  
ards Task Force meeting prior to 2020 Stock Show.



January 2020  
Temporary Wash Racks In Use



Photo Courtesy: Mayor's Office of the National Western Center Construction Program



January 2020

This drone footage was shot on January 6<sup>th</sup>, 6 days before Stock Show.



Photo Courtesy: National Western Stock Show



January 2020

This drone footage was shot on January 17<sup>th</sup>



Photo Courtesy: National Western Stock Show





Photo Courtesy: National Western Stock Show





Photo Courtesy: Mayor's Office of the National Western Center Construction Program





Photo Courtesy: Mayor's Office of the National Western Center Construction Program



## Campus Progress Video Update





**Text “updates” or “noticias” to 64600**



[www.nationalwesterncenter.com](http://www.nationalwesterncenter.com)